

KTX4/SKT4 is the newest Terma Technologie offer and belongs to the most innovative heaters in the world. You can control and program it remotely via IR controller or monitor working time and power consumption on build in display. Its beauty, smart functionality and user friendly interface makes it very attractive. KTX4/SKT4 has extremely low power consumption which makes it environment - friendly. Depending on the version they are compatible with Class I heating elements (KTX) or Class II (SKT) respectively.

KTX-4 posses following properties:

- 5-step temperature setting within a range of 30-60°C,
- IR module to communicate with external controller
- Drying function (from 1h to 4h)
- Actual work counter – enables to control power consumption
- Membrane keyboard
- 3 finishes – white, silver and chrome
- IP x5
- 1st Class security
- Power: 200W, 300W, 400W, 600W, 800W, 1000W
- Co-operates with Terma-SPLIT
- ANTIFREEZE function (prevents heating liquid from freezing)
- Double overheat protection
- Symmetric casing (installation on both sides)



TERMA-SPLIT System

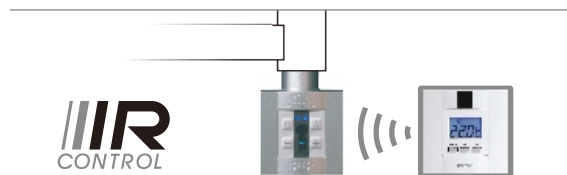

- IR programmer enables:
- remote steering of the heater
 - multi – zone setting 24h timer
 - ambient temperature sensor and temperature regulation
 - drying function setting

TERMA-SPLIT System

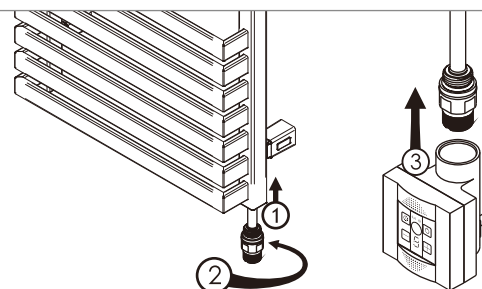

technical data

1. Control Box:

- 1.1 Front Panel,
- 1.2 Grab screw,
- 1.3 Supply cord;

2. Heater:

- 2.1 Head (Cap),
- 2.2 Case seal,
- 2.3 Head seal,
- 2.4 Radiator temperature sensor (protection against radiator temperature raise above 60°C),
- 2.5 Heating element

| KTX4 Control Box | | | |
|------------------|-------------------------------|-----------------|-----------|
| Type | Control box protection degree | external thread | Voltage |
| KTX4 | IP 65 | G ½" | 230V 50Hz |

&

| Terma – Split heating element | |
|-------------------------------|------------------------------------|
| power [W] | length of the heating element [mm] |
| 200 | 285 |
| 300 | 310 |
| 400 | 345 |
| 600 | 375 |
| 800 | 485 |
| 1000 | 575 |

